

# ATELIER ARETI

## PRODUCT

Axis 177

Pendant light / 4 cones and 1 globe

## MATERIALS AND COLOUR OPTIONS

Powder coated metal; brushed brass; white glass

## VERSIONS

Brushed brass middle connector, ring, ceiling attachment, tube and cones; white reflectors

177OL-P01-BR01

Brushed brass middle connector and ring; black ceiling attachment, tube and cones; white reflectors

177OL-P01-ME01

Brushed brass middle connector and ring; white ceiling attachment, tube and cones; white reflectors

177OL-P01-ME02

## TECHNICAL DETAILS

Cones: 4 x G9 LED 5W max

Globe Ø200: 1 x E27 LED 10W max (US: E26)

110-230V

IP20

Light bulbs not included

## NOTE

Mirrored bulbs reflect a lot of heat back to the lamp holder. Depending on the space around the lamp holder, the heat might build up above the recommended temperature, especially if the heat is trapped when moving upwards. For this reason, the max. wattage indicated does not apply to mirrored bulbs, but to non mirrored bulbs only. If mirrored bulbs are desired, only those with a low wattage (such as LEDs) should be used. The max. wattage for mirrored bulbs is 5 watt LED (equivalent of 40 watt traditional bulb)

## MADE IN

Germany

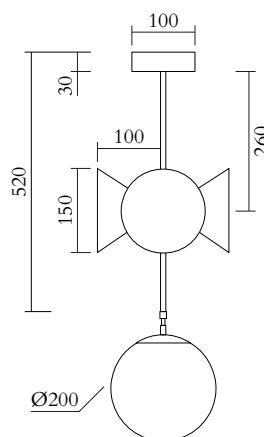

Sizes in mm. Flat attachments available only on request. Variations in colour and size are available for some collections, please contact Areti for more details.

Our collections are hand made and made to order, small irregularities in shape or surface will occur, they are inherent to the hand made process and should not be seen as flaws. For detailed information on any products: [contact@atelierareti.com](mailto:contact@atelierareti.com)

# ATELIER ARETI

## PRODUCT

Axis 177

Pendant light / 4 globes

## MATERIALS AND COLOUR OPTIONS

Powder coated metal; brushed brass; white glass

## VERSIONS

Brushed brass middle connector, ring, ceiling attachment, tube; white reflectors 177OL-P02-BR01

Brushed brass middle connector, ring; black ceiling attachment, tube; white reflectors 177OL-P02-ME01

Brushed brass middle connector, ring; white ceiling attachment, tube; white reflectors 177OL-P02-ME02

## TECHNICAL DETAILS

Globe Ø150: 4 x G9 LED 5W max

Globe Ø200: 1 x E27 LED 10W max (US: E26)

110-230V

IP20

Light bulbs not included

## MADE IN

Germany

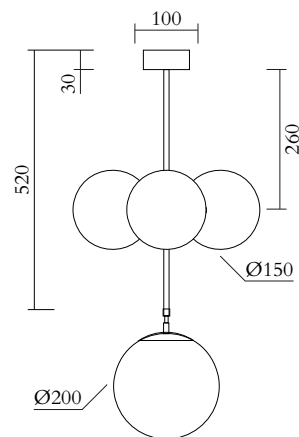

Sizes in mm. Flat attachments available only on request. Variations in colour and size are available for some collections, please contact Areti for more details.

Our collections are hand made and made to order, small irregularities in shape or surface will occur, they are inherent to the hand made process and should not be seen as flaws. For detailed information on any products: [contact@atelierareti.com](mailto:contact@atelierareti.com)

# ATELIER ARETI

## PRODUCT

Axis 177  
Pendant light / 4 cones

## MATERIALS AND COLOUR OPTIONS

Powder coated metal; brushed brass; white glass

## VERSIONS

Brass middle connector and ring; black ceiling tube and attachment; black small cones (white reflectors); black large cone (white reflector) 177OL-P03-ME01

Brass middle connector and ring; white ceiling tube and attachment; white small cones (white reflectors); white large cone (white reflector) 177OL-P03-ME02

Brass middle connector, ring, ceiling attachment and tube; black small cones (white reflectors); white large cone (white reflector) 177OL-P03-ME03

Brass middle connector and ring; black ceiling tube and attachment; brass small cones (white reflectors); black large cone (white reflector) 177OL-P03-ME04

Brass middle connector and ring; white ceiling tube and attachment; brass small cones (white reflectors); white large cone (white reflector) 177OL-P03-ME05

## TECHNICAL DETAILS

Small cones: 4 x G9 LED 5W max

Large cone: 1 x E27 LED 10W max (US: E26)

110-230V

IP20

Light bulbs not included

## NOTE

Mirrored bulbs reflect a lot of heat back to the lamp holder. Depending on the space around the lamp holder, the heat might build up above the recommended temperature, especially if the heat is trapped when moving upwards. For this reason, the max. wattage indicated does not apply to mirrored bulbs, but to non mirrored bulbs only. If mirrored bulbs are desired, only those with a low wattage (such as LEDs) should be used. The max. wattage for mirrored bulbs is 5 watt LED (equivalent of 40 watt traditional bulb)

## MADE IN

Germany

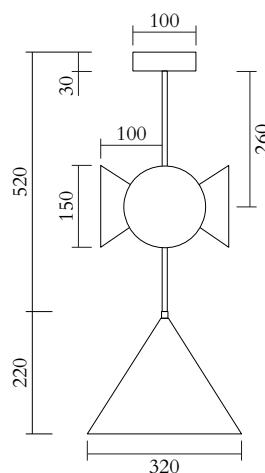

Sizes in mm. Flat attachments available only on request. Variations in colour and size are available for some collections, please contact Areti for more details.

Our collections are hand made and made to order, small irregularities in shape or surface will occur, they are inherent to the hand made process and should not be seen as flaws. For detailed information on any products: [contact@atelierareti.com](mailto:contact@atelierareti.com)

# ATELIER ARETI

## PRODUCT

Axis 177

Pendant light / Metal cone and 4 globes

## MATERIALS AND COLOUR OPTIONS

Powder coated metal; brushed brass; white glass

## VERSIONS

Brass middle connector and ring; black tube, ceiling attachment and cone (white reflector)

177OL-P04-ME01

Brass middle connector and ring; white tube, ceiling attachment and cone (white reflector)

177OL-P04-ME02

Brass middle connector and ring and tube; black ceiling attachment and cone (white reflector)

177OL-P04-ME03

## TECHNICAL DETAILS

Globe Ø150: 4 x G9 LED 5W max

Cone: 1 x E27 LED 10W max (US: E26)

110-230V

IP20

Light bulbs not included

## NOTE

Mirrored bulbs reflect a lot of heat back to the lamp holder. Depending on the space around the lamp holder, the heat might build up above the recommended temperature, especially if the heat is trapped when moving upwards. For this reason, the max. wattage indicated does not apply to mirrored bulbs, but to non mirrored bulbs only. If mirrored bulbs are desired, only those with a low wattage (such as LEDs) should be used. The max. wattage for mirrored bulbs is 5 watt LED (equivalent of 40 watt traditional bulb)

## MADE IN

Germany

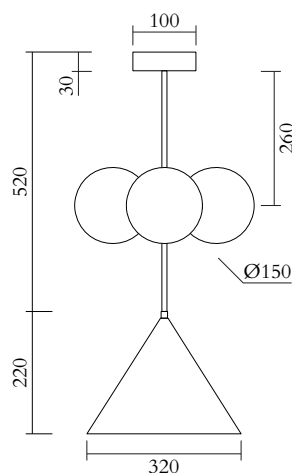

Sizes in mm. Flat attachments available only on request. Variations in colour and size are available for some collections, please contact Areti for more details.

Our collections are hand made and made to order, small irregularities in shape or surface will occur, they are inherent to the hand made process and should not be seen as flaws. For detailed information on any products: [contact@atelierareti.com](mailto:contact@atelierareti.com)

# ATELIER ARETI

## PRODUCT

Axis 177

Pendant light / Glass cone and 4 globes

## MATERIALS AND COLOUR OPTIONS

Powder coated metal; brushed brass; white glass

## VERSIONS

Brass middle connector, ring, tube and ceiling attachment; white glass cone 177OL-P05-BR01

Brass middle connector and ring; black tube and ceiling attachment; white glass cone 177OL-P05-ME01

Brass middle connector and ring; white tube and ceiling attachment; white glass cone 177OL-P05-ME02

## TECHNICAL DETAILS

Globe Ø150: 4 x G9 LED 5W max

Cone: 1 x E27 LED 10W max (US: E26)

110-230V

IP20

Light bulbs not included

## NOTE

Mirrored bulbs reflect a lot of heat back to the lamp holder. Depending on the space around the lamp holder, the heat might build up above the recommended temperature, especially if the heat is trapped when moving upwards. For this reason, the max. wattage indicated does not apply to mirrored bulbs, but to non mirrored bulbs only. If mirrored bulbs are desired, only those with a low wattage (such as LEDs) should be used. The max. wattage for mirrored bulbs is 5 watt LED (equivalent of 40 watt traditional bulb)

## MADE IN

Germany

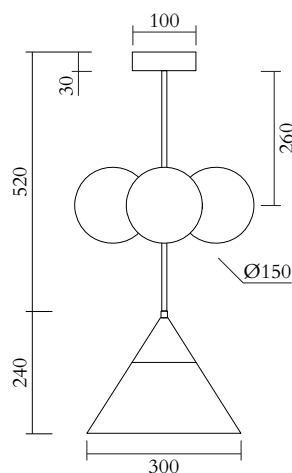

Sizes in mm. Flat attachments available only on request. Variations in colour and size are available for some collections, please contact Areti for more details.

Our collections are hand made and made to order, small irregularities in shape or surface will occur, they are inherent to the hand made process and should not be seen as flaws. For detailed information on any products: [contact@atelierareti.com](mailto:contact@atelierareti.com)