

# MARC WOOD



The Greenstone collection takes inspiration from ornamental Indian architecture and draws upon traditional stone masonry techniques combined with state of the art manufacturing processes. The Rajasthan Greenstone is sourced from north east India, before being delicately shaped by London based stonemasons.

Available in both small and large, the collection can be hung as a single piece or in multiples to create statement installations for show stopping interiors.

## Greenstone cluster - 5 piece

### Dimensions cm

W 50cm x H 200cm x D 50cm

### Dimensions inch

W 19.7in x H 78.7in x D 19.7in

### Material

Glass + Metal + Marble

### Finishes - glass

Pearl white

### Marble

Verde Guatemala

### Weight

10kg (22lbs)

### Finishes - metal

Brushed brass, Brushed nickel  
Blackened steel

### Suspension

2m (79in), cable - black, fabric covered

### Canopy

White finish

Bespoke colours available on request

48cm (18.9in) x 2.5cm (1in)

Plate can be inset or surface mounted

### 240V Illumination

Integrated LED

Lumens: 900lm

Colour Temperature: 2700K

Dimmable: LED dimmer required

### 120V illumination

Integrated LED

Lumens: 900lm

Colour Temperature: 2700K

Dimmable: LED dimmer required

### Driver

Dimmable driver included

Ceiling Plate

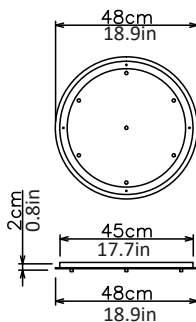

Pendant

